

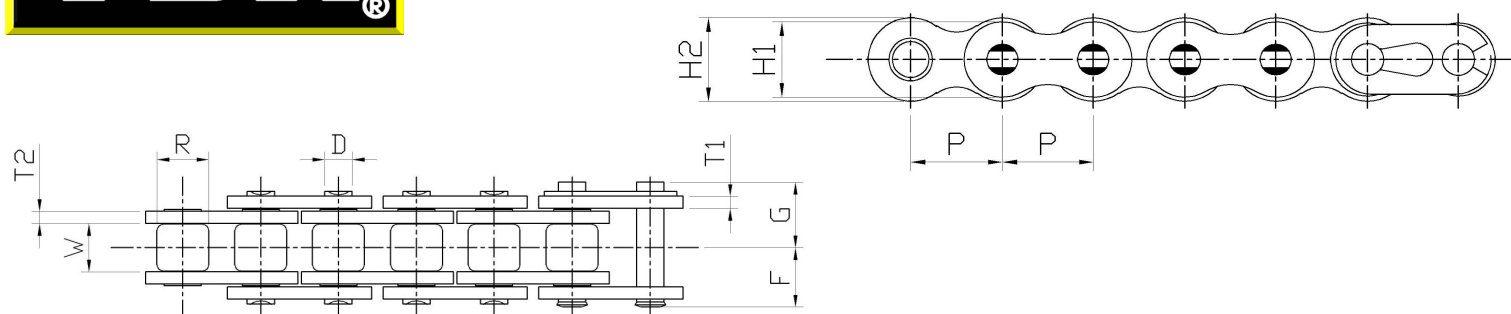

MOTORCYCLE CHAIN SPECIFICATION



YBN Chain No.	Pitch xWidth		Roller	Links				Pin			Average	Cylinder cc (max)
	P x W			Dia	Height		Thickness		Dia	Lengths		
	inch	m/m	R	H1	H2	T1	T2	D	F	G	Strength	
Regular												
25	1/4"x1/8"	6.35x3.18	3.30	5.00	5.80	0.75	0.75	2.30	3.30	4.50	400	
415E	1/2"x3/16"	12.70x4.76	7.77	10.20	10.20	1.00	1.50	3.96	6.15	7.30	1650	50cc
420	1/2"x1/4"	12.70x6.35	7.77	10.20	11.80	1.50	1.50	3.96	7.50	8.40	1750	90cc
425	1/2"x5/16"	12.70x7.94	7.77	10.20	11.80	1.50	1.50	3.96	8.55	9.70	1800	100cc
428	1/2"x5/16"	12.70x7.94	8.50	10.20	11.90	1.50	1.50	4.44	8.55	9.70	1850	125cc
428S	1/2"x5.2	12.70x5.2	8.50	10.20	11.90	1.50	1.50	4.44	7.00	8.40	1850	125cc
520	5/8"x1/4"	15.875x6.35	10.16	13.00	14.80	2.00	2.00	5.06	8.50	10.10	3100	250cc
525	5/8"x5/16"	15.875x7.94	10.16	13.00	14.80	2.00	2.00	5.06	9.30	10.90	3100	400cc
530	5/8"x3/8"	15.875x9.53	10.16	13.00	14.80	2.00	2.00	5.06	10.10	11.60	3100	500cc
Heavy Duty												
25H	1/4"x1/8"	6.35x3.18	3.30	5.00	5.80	1.00	1.00	2.30	4.50	5.10	560	
25FH	1/4"x1/8"	6.35x3.18	3.30	5.00	5.80	0.75	0.75	2.30	3.30	4.50	400	
415H	1/2"x3/16"	12.70x4.76	7.77	10.20	11.80	1.50	1.50	3.96	6.40	7.80	1750	70cc
420H	1/2"x1/4"	12.70x6.35	7.77	10.20	11.80	1.80	1.80	3.96	8.10	8.95	1900	125cc
428H	1/2"x5/16"	12.70x7.94	8.50	11.20	12.20	1.80	1.80	4.44	8.90	10.20	2300	150cc
428HD	1/2"x5/16"	12.70x7.94	8.50	11.20	12.20	2.00	2.00	4.44	9.30	10.70	2600	200cc
520H	5/8"x1/4"	15.875x6.35	10.16	13.00	14.80	2.40	2.40	5.06	9.30	10.90	3300	500cc
525H	5/8"x5/16"	15.875x7.94	10.16	13.00	14.80	2.40	2.40	5.06	10.00	11.60	3300	750cc
530H	5/8"x3/8"	15.875x9.53	10.16	13.00	14.80	2.40	2.40	5.06	10.90	12.40	3300	750cc
O-Ring Chain Series												
Standard												
520SO	5/8"x1/4"	15.875x6.35	10.16	13.00	14.80	2.00	2.00	5.06	10.20	10.60	3100	
525SO	5/8"x5/16"	15.875*7.94	10.16	13.00	14.80	2.00	2.00	5.06	11.00	11.40	3100	
530SO	5/8"x3/8"	15.875x9.53	10.16	13.00	14.80	2.00	2.00	5.06	11.85	12.25	3100	
Heavy Duty												
428HO	1/2"x5/16"	12.70x7.94	8.50	11.20	12.20	1.80	1.80	4.44	10.10	11.50	2300	200/150
520HO	5/8"x1/4"	15.875x6.35	10.16	13.00	14.80	2.40	2.40	5.06	10.90	11.30	3300	
525HO	5/8"x5/16"	15.875x7.94	10.16	13.00	14.80	2.40	2.40	5.06	11.70	12.10	3300	
530HO	5/8"x3/8"	15.875x9.53	10.16	13.00	14.80	2.40	2.40	5.06	12.55	12.95	3300	
Extra Heavy Duty												
520FHO	5/8"x1/4"	15.875x6.35	10.16	15.10	15.10	2.40	2.40	5.24	10.90	11.30	3700	250/500
525FHO	5/8"x5/16"	15.875x7.94	10.16	15.10	15.10	2.40	2.40	5.24	11.70	12.10		
530FHO	5/8"x3/8"	15.875x9.53	10.16	15.10	15.10	2.40	2.40	5.24	12.55	12.95	3700	900/650
X-Ring Chain Series												
Heavy Duty												
520FSX	5/8"x1/4"	15.875x6.35	10.16	15.10	15.10	2.00	2.00	5.24	10.20	10.60	3600	750/750
525FSX	5/8"x5/16"	15.875x7.94	10.16	15.10	15.10	2.00	2.00	5.24	11.00	11.40	3000	400/400
530FSX	5/8"x3/8"	15.875x9.53	10.16	15.10	15.10	2.00	2.00	5.24	11.85	12.25	3400	750/NA
Extra Heavy Duty												
520FHX	5/8"x1/4"	15.875x6.35	10.16	15.10	15.10	2.40	2.40	5.24	10.90	11.30	3800	1000/750
525FHX	5/8"x5/16"	15.875x7.94	10.16	15.10	15.10	2.00	2.00	5.24	11.70	12.10	4000	1000/750
530FHX	5/8"x3/8"	15.875x9.53	10.16	15.10	15.10	2.40	2.40	5.24	12.55	12.95	4000	1000/750