

NOTE TO CATV SYSTEM INSTALLER:

This reminder is provided to call the CATV system installer's attention to Article 820-40 of the NEC that provides guidelines for proper grounding and, in particular, specifies that the cable ground shall be connected to the grounding system of the building, as close to the point of cable entry as practical.

WARNING: To prevent fire or shock hazard, do not expose this product to rain or moisture. This unit for indoor use only.





CAUTION

RISK OF ELECTRIC SHOCK.
DO NOT OPEN



CAUTION: TO REDUCE THE RISK OF ELECTRIC SHOCK, DO NOT REMOVE COVER OR BACK. NO USER-SERVICE-ABLE PARTS INSIDE. REFER SERVICING TO QUALIFIED PERSONNEL.

 The lightning flash with arrowhead symbol, within an equilateral triangle, is intended to alert the user to the presence of un-insulated "dangerous voltage" within the product's enclosure that may be of sufficient magnitude to constitute a risk of electric shock to persons.

 The exclamation point with an equilateral triangle is intended to alert the user to the presence of important operating and maintenance (servicing) instructions in the literature accompanying the appliance.

Notice: The changes or modifications not expressly approved by the party responsible for compliance could void the user's authority to operate the equipment.

You can use your PH61153 Audio/Video Selector to connect up to four audio/video components (such as direct-to-home satellite systems, VCRs, DVD players, laserdisc players, cable boxes, or video game system) and multimedia speakers to a single TV. You can connect S-video cables directly to the selector for optimum picture quality.

Note: Depending upon your audio/video system setup, you might also need additional cables or adapters to connect all of the desired components. Use phono cables to connect audio and video devices, and S-video cables to connect video devices to the selector.

Note: To receive video output from the **OUT** S-video Jack on the back of the selector, you must use an S-video cable to connect a video source to one of the **IN** S-video jacks

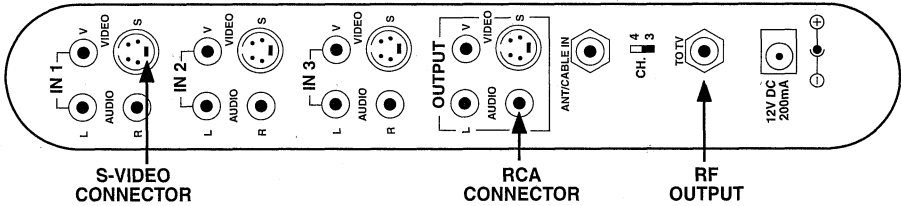

Placing the Selector:

You can set the selector on just about any flat surface. For the best results, do not place it on top of a TV or other electrical appliance.

Important: If you place the selector on top of your TV, electromagnetic interference from the TV might distort the sound from any devices connected to the selector. If this happens, move the selector away from the TV.

Connecting Devices to the Selector:

1. Connect the sound outputs for each device to a set of IN AUDIO jack (1-4) on the back of the selector.
2. If a device you want to connect does not have an S-video cable, connect its video output to IN VIDEO for that device on the back of the selector, Or, if the device has an S-video cable, connect it to the S-video IN VIDEO jack for that device on the back of the selector.
3. If the TV or monitor you want to connect does not have an S-video cable, connect its video input to OUT VIDEO on the back of the selector.

4. Auto Detector

When the PH61153 doesn't detect the signal from the 4 inputs, it will automatically process the signal from the "F" connector of "ANT IN" to RF output.

5. Synchronize Recording function:

If you choose any of the 4 inputs to process the program, you may also record the program at the same time from the Audio/Vidéo/S-video output.

Automatic Selection of Video/Audio Sources:

1. Press MODE key and the AUTO LED indicator will turn on. The unit is now in AUTO Mode
2. This unit has 4 audio/video inputs. It can automatically select one of the 4 audio/video sources. The choice is made upon the availability of these video signals. If video program is available at the "IN 2" input, this device automatically selects the "IN 2" video program and shows on your TV set via the "TO TV" output connectors.
3. In the case of contention and collision among audio/video sources, an order of priority has been assigned to these inputs as follows:

Video/Audio Input	Priority
IN 1	Least Priority
IN 2	First Priority
IN 3	Second Priority
IN 4	Third Priority

Example: In the case that both "IN 1" input and "IN 2" input have audio/video programs, the unit will select "IN 2" input for TV viewing.

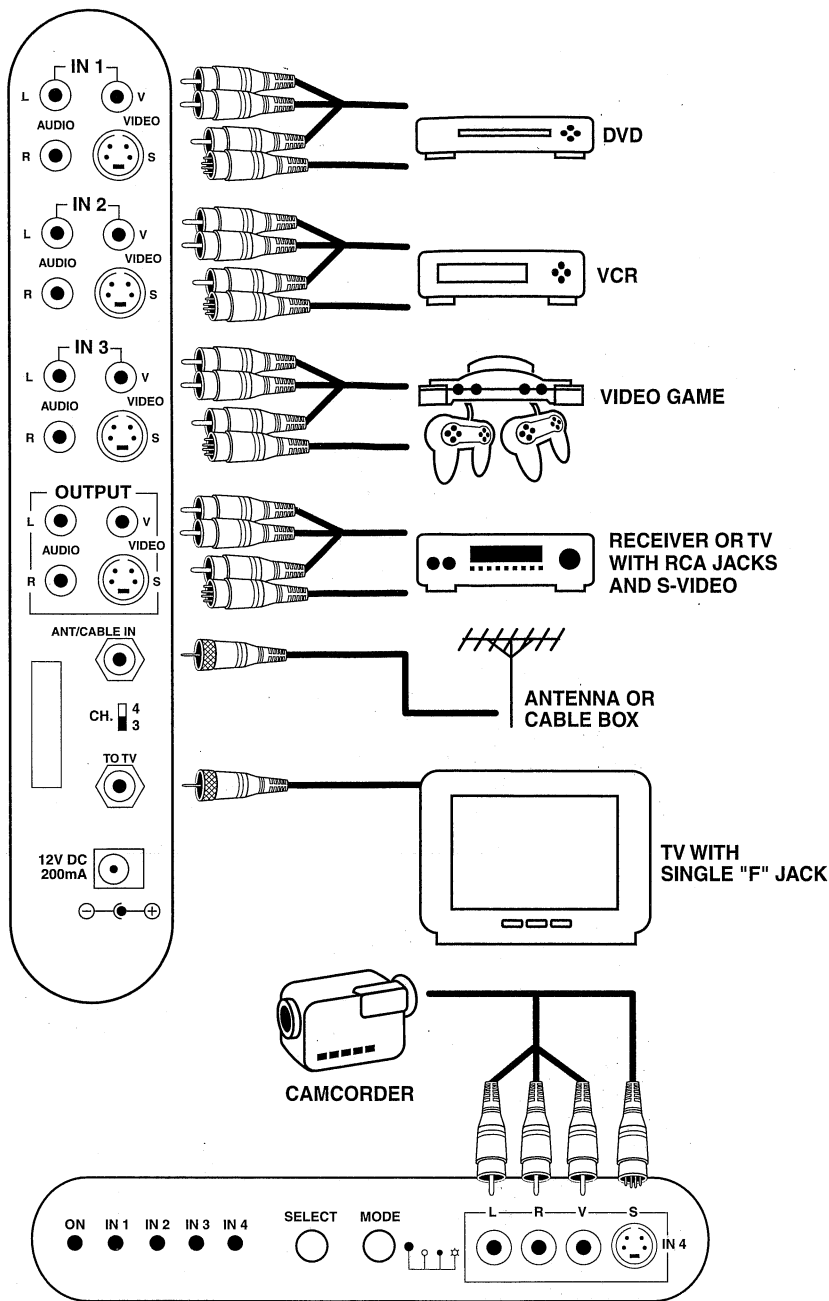

4. In case that there is no audio/video from "IN 2", "IN 3" or "IN 4" inputs, the unit will always select the "IN 1" input.
5. In case there is no audio/video from any audio/video sources, the unit will stay automatically at cable input.

Manual Selection of Audio/Video Sources:

1. Press "MODE" Key again until the mode led indicator turns off. The unit is now in manual mode.
2. Use "Select" Key to select audio/video sources in rotation.
3. The LED will indicate which source has been selected.

Scanning the Audio/Video Sources:

1. Press "MODE" Key until the MODE LED indicator is blinking. The unit is now in SCAN mode.
2. The unit will automatically scan the available audio/video sources.
3. The speed of the scan can be adjusted by pressing the "MODE" Key repeatedly and can be monitored by the blinking of the MODE LED indicator.

Note: You cannot use both the S-Video input and composite video input at the same time. When you use S-Video input, the video input is automatically turned off.