

Specifications

11.7~12.2 GHz Internal Reference PLL LNB: ZK-PF1

1. Input Frequency Range	11.7 ~ 12.2 GHz
2. Output Frequency Range	950 ~ 1450 MHz
3. Local Oscillator Frequency	10.75 GHz
4. Input Waveguide Flange	WR-75
5. Conversion Gain	50 ~ 60 dB
6. Gain Variation Over Temperature	± 2 dB
7. Gain Flatness Over 50 MHz 500 MHz	± 1 dB ± 2 dB
8. Noise Figure	0.7 dB (Typ.)
9. Output Power (@1dB Gain Compression Point)	0 dBm (Min.)
10. Phase Noise	Meet IESS 308 / 309
11. Local Stability	± 2.5 ppm
12. Output V.S.W.R.	2 : 1
13. Output Connector	F Type, Female (75Ω)
14. D.C Supply Voltage	15 ~ 20 V
15. D.C Current Consumption	200 mA (Max.)
16. Operating Temperature	- 40 °C ~ + 55 °C
17. Weight	400 g (Max.)

Mechanical Drawing

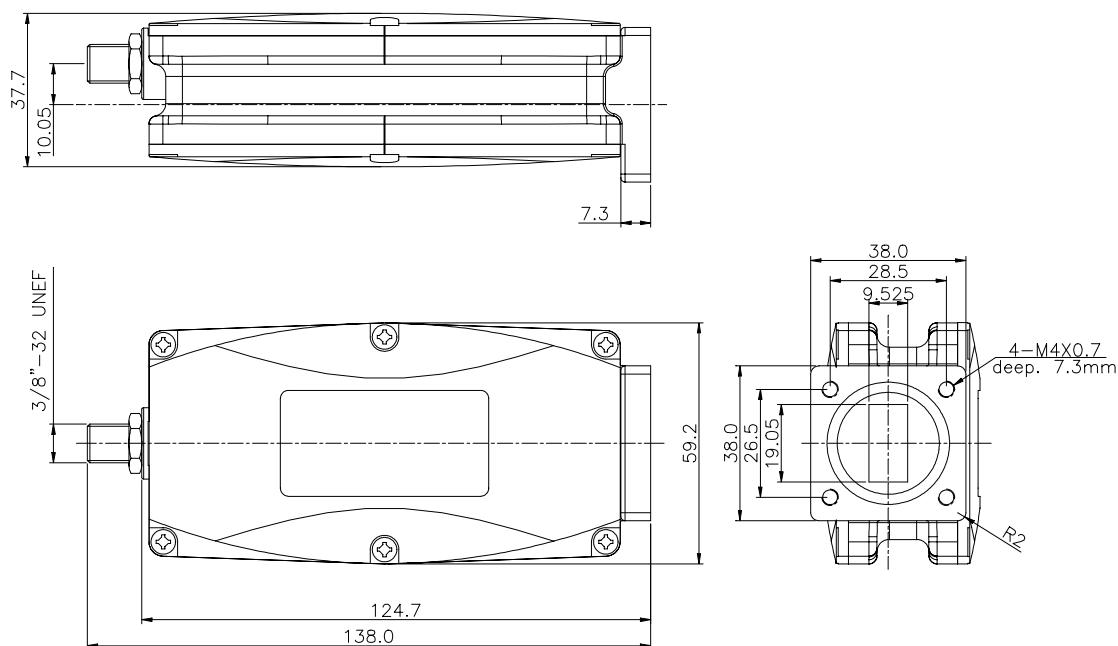

Unit: mm